

Mamiya

Plate Holder Adapter for Mamiya RB

INSTRUCTIONS

www.ianbfoto.com

This plate holder adapter can be used for photographing on plates by installing the plate holder for Mamiya C on the Mamiya RB 67. Single exposures can be made economically and efficiently by using a plate ($2\frac{1}{2} \times 3\frac{1}{2}$ inch, 6.5×9 cm) or cut film (quarter size of $4\frac{3}{4} \times 6\frac{1}{2}$ inch, 12×16.5 cm or $2\frac{1}{2} \times 3\frac{1}{2}$ inch, 6.5×9 cm).



Nomenclature of Parts

Plate holder adapter for Mamiya RB

1. Outside frame
2. Holding frame
3. Outside frame catch

Plate Holder for Mamiya C

4. Dark slide
5. Lock lever
6. Plate carrier
7. Film sheath
8. Leatherette covering

Note:

Plate holders covered with leatherette (8) can be used; however, holders without a leatherette covering cannot be utilized.

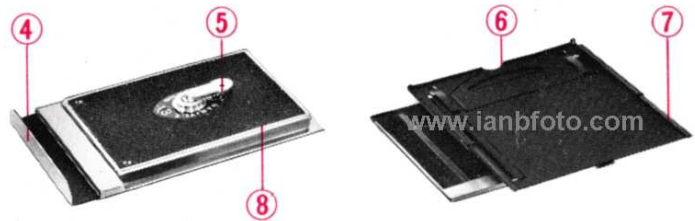
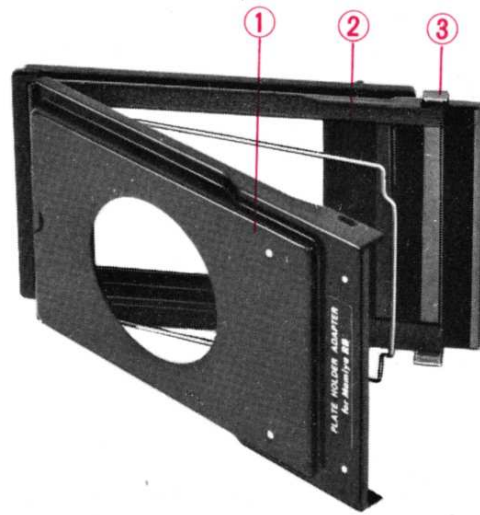

- 2 -

Attaching to the Camera

1. Move the upper and lower slide locks (b) in the direction opposite to the arrow (►), while pressing the slide lock release lever (a).
2. Hold the plate holder adapter in a condition that the catch (3) comes to the right side; then fit the plate holder adapter while pressing it to the left side of the revolving adapter.
3. Secure the plate holder adapter by fully shifting the upper and lower slide locks in the arrow direction.

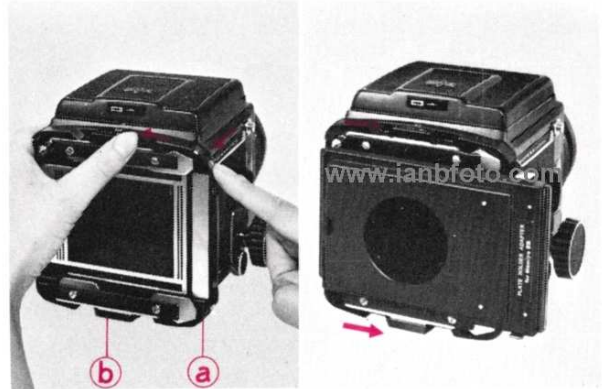

Detaching from the Camera

Detach the plate holder adapter after shifting the upper and lower slide locks in the direction opposite to the arrow (►), while pressing the slide lock release lever.

- 3 -

Loading the Plate Holder

When Using Plates

First, pull out the dark slide (4) from the plate holder; then, while rotating the lock lever (5) located on the rear side of the plate holder approximately $\frac{1}{4}$ revolution after raising it, the plate carrier (6) will spring out.

When using a plate, previously remove the film sheath (7) by sliding it horizontally. In this condition, gradually insert a plate into the plate carrier (6) grooves. When inserting a plate, always face the emulsion side upward.

After inserting a plate, pull out the lock lever and turn it $\frac{1}{4}$ revolution; then fold it upward and insert the dark slide as it originally was.

When Using Cut Films

When using cut film, previously insert film into the film sheath (7); then insert the film sheath into the plate carrier by the same procedures as used for plates.

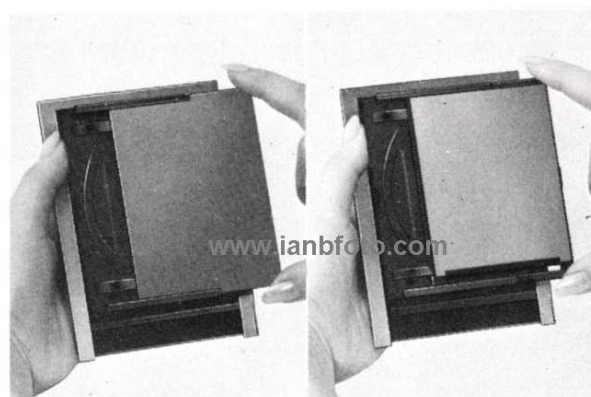

- 4 -

Note:

A plate (or cut film) must be inserted into the plate holder in a darkroom. Do not leave or expose the plate holder containing the plate or cut film under direct sunlight or a bright room.

When the plate holder is not used, always pull out the dark slide from the plate holder to discriminate between whether or not a film (or plate) is loaded.

When using a cut film "one-quarter size"

taken from $4\frac{3}{4} \times 6\frac{1}{2}$ inch, 12×16.5 cm, use a type J film sheath. To equally divide a film in four parts, a convenient, exclusive cutter is available.

When using a cut film of $2\frac{1}{2} \times 3\frac{1}{2}$ inch, 6.5×9 cm, use a type D film sheath.

Upon loading holders, by folding the lock lever upward over "E", a figure will appear in the lower window, so utilize these figures as a memorandum on photographing pictures. Figures from 1 to 3 are available.

Film sheath

Type J



Type D



- 5 -

Installing the Plate Holder

By pressing the upper and lower outside frame catches (3) to the inner side, the outside frame (1) can be opened. Fully open the outside frame (1) and the holding frame (2), and closely press the plate holder to the plate holder adapter. While holding the plate holder so that it does not slip, shut the holding frame and the outside frame as they initially were. While securely pressing the right upper and lower sides of the outside frame, hook the catches (3) on both sides.

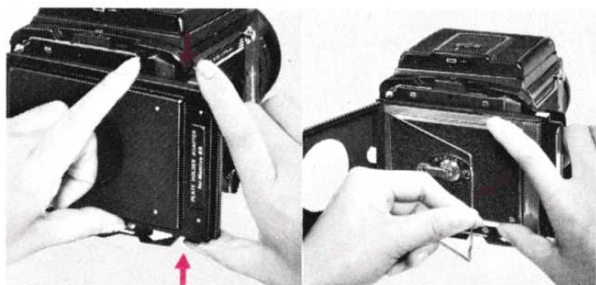

Photographing

At first, pull out the dark slide. By raising the lock lever (5) and turning it $\frac{1}{4}$ revolution, the plate or cut film is shifted to the focusing plane by spring action, and the subject can be photographed in this condition. When photographing is completed, pull out the lock lever and turn it $\frac{1}{4}$ revolution, then fold the lever to the right. An E symbol will appear, indicating that the plate or cut film has already been exposed. Don't forget to reinsert the dark slide!



- 6 -

Replacing the Plate Holder

Release the catches (3) by pressing them from both sides, then open the outside frame by holding both ends. Next, hold the plate holder, open it nearly 90°, and detach it from its tip portion. Thus, the plate can be removed from the holding frame.

When replacing the plate holder, do not handle it by holding only the dark slide; this will cause light to leak in.



Mamiya
CAMERA CO., LTD.