

# Mamiya

PARTS CATALOG

for

#1 Type 791,870 and 871 SEIKO SHUTTER



**MAMIYA AMERICA CORPORATION**

8 Westchester Plaza, Elmsford, NY 10523 • 914-347-3300



P.C.78-12-SE791

509-0037  
for type 870  
( Brass )

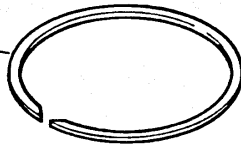

507-0037  
for type 791  
( Ni )

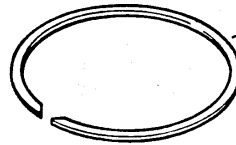

812-0037  
for type 871  
( BNi )

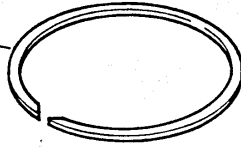

791-0005

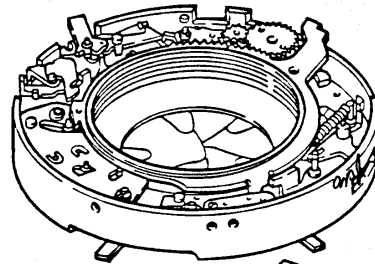
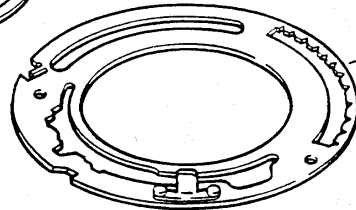

791-1112

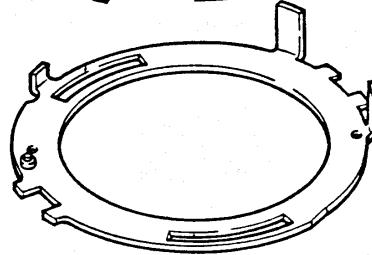

791-1216

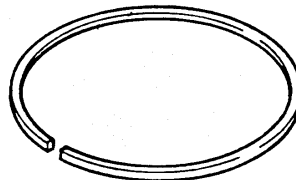

791-1214

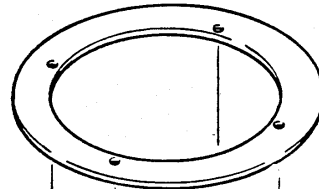

000-0320



001-0311



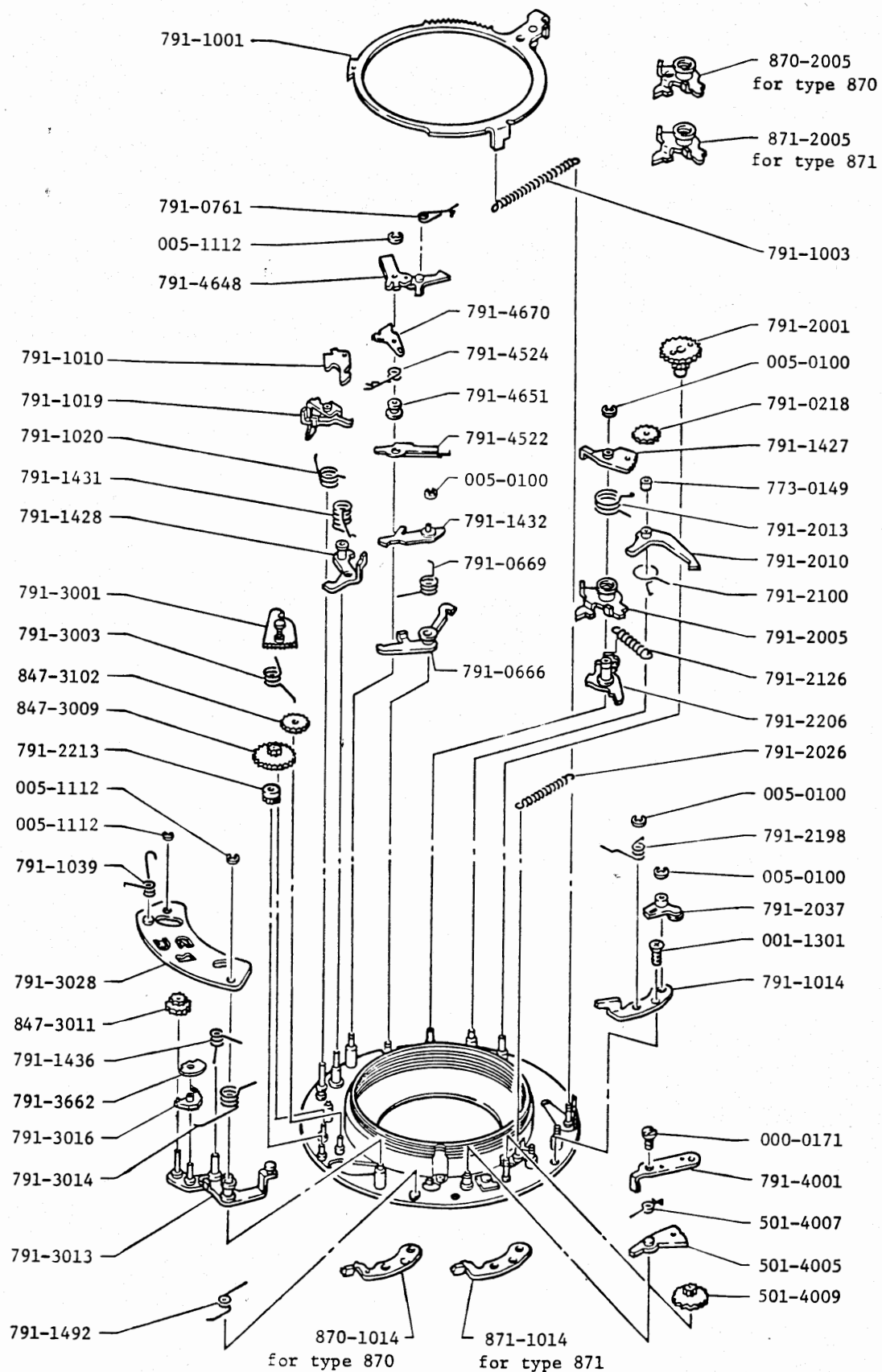

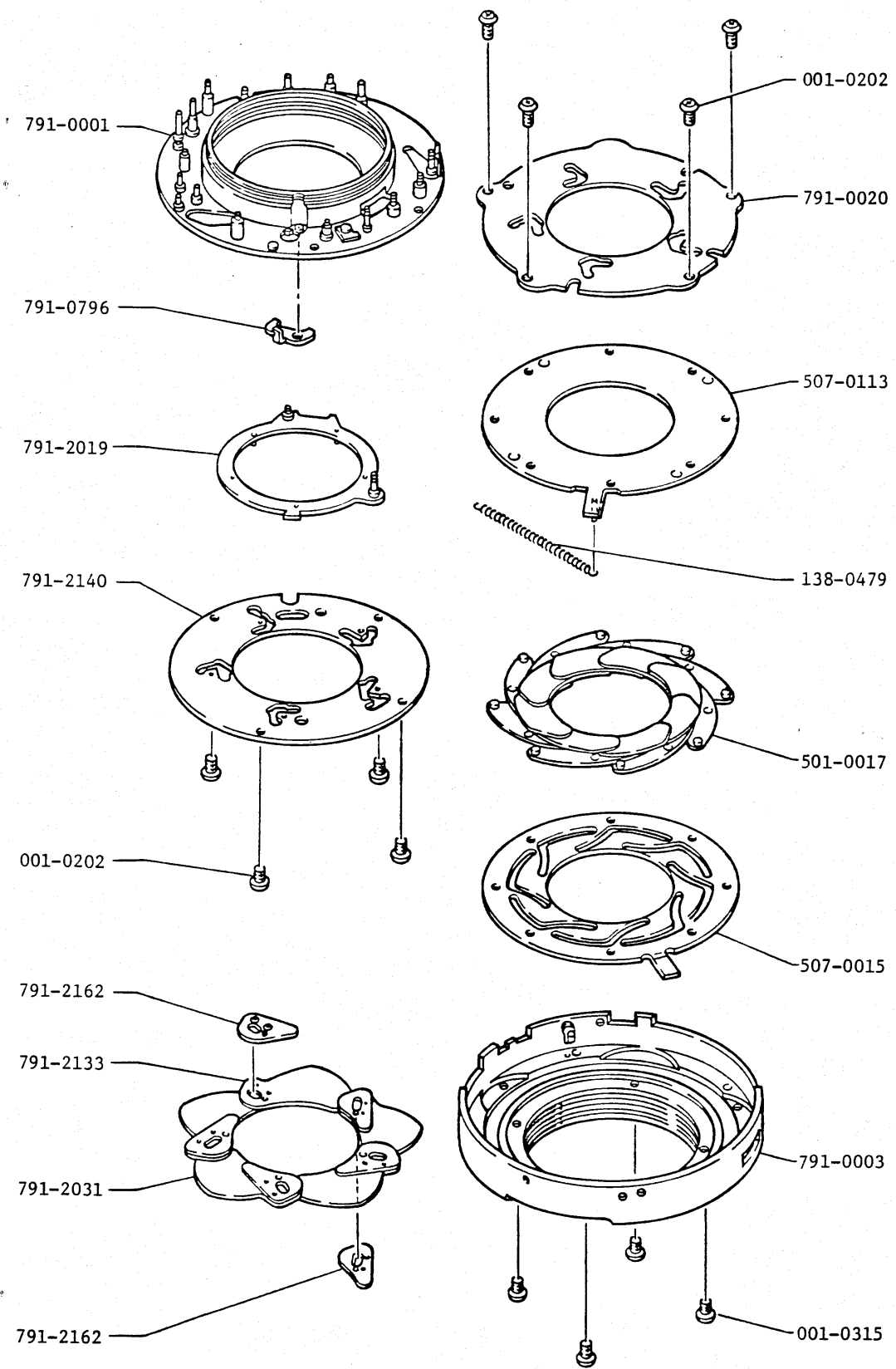

Parts List for  
#1 Type 791,870 and 871 SEIKO SHUTTER

Parts No.	Description	Pcs.	Ref. Page
000-0171	Screw	1	2
000-0320	Screw	2	1
001-0202	Screw	4	3
001-0311	Screw	2	1
001-0315	Screw	4	3
001-1301	Screw	1	2
005-0100	E ring	4	2
005-1112	E ring	3	2
138-0479	Spring	1	3
501-0017	Diaphragm blade	8	3
501-4005	SG 1st. gear	1	2
501-4007	Spring	1	2
501-4009	SG escape wheel	1	2
507-0015	Diaphragm blade actuating plate	1	3
507-0037	Retainer for type 791	1	1
507-0113	Diaphragm operating ring	1	3
773-0149	Collar	1	2
791-0001	Base plate	1	3
791-0003	Shutter casing	1	3
791-0005	Speed setting disk	1	1
791-0020	Diaphragm blade holding plate	1	3
791-0218	Idle gear	1	2
791-0666	Control lever	1	2
791-0669	Spring	1	2
791-0761	Spring	1	2
791-0796	Bounce prevent lever	1	3
791-1001	Cocking ring	1	2
791-1003	Cocking ring spring	1	2
791-1010	Start latch	1	2
791-1014	Base plate	1	2
791-1019	Release lever	1	2
791-1020	Spring	1	2
791-1039	Spring	1	2
791-1112	Charge ring	1	1

Parts No.	Description	Pcs.	Ref. Page
791-1214	Fixing ring	1	1
791-1216	Spacer	1	1
791-1427	Set gear (B)	1	2
791-1428	Drive lever	1	2
791-1431	Spring	1	2
791-1432	Latch	1	2
791-1436	Spring	1	2
791-1492	Spring	1	2
791-2001	Set gear (A)	1	2
791-2005	Drive cam	1	2
791-2010	Dog lever	1	2
791-2013	Drive spring	1	2
791-2019	Sector actualing ring	1	3
791-2026	Spring	1	2
791-2031	Shutter sector (A)	4	3
791-2037	Sector opening lever	1	2
791-2100	Spring	1	2
791-2126	Spring	1	2
791-2133	Shutter sector (B)	1	3
791-2140	Sector holding plate	1	3
791-2162	Shutter sub sector (B)	2	5
791-2198	Spring	1	2
791-2206	Drive cam (B)	1	2
791-2213	Middle gear	1	2
791-3001	RG 1st. Gear	1	2
791-3003	Spring	1	2
791-3013	Base plate	1	2
791-3014	Spring (A)	1	2
791-3016	Base	1	2
791-3028	RG upper plate	1	2
791-3662	Pawl	1	2
791-4001	SG upper plate	1	2
791-4522	Synchro contact	1	2
791-4524	Spring	1	2
791-4648	MX setting lever	1	2

---

Parts No.	Description	Pcs.	Ref. Page
791-4651	Pole	1	2
791-4670	Click plate	1	2
847-3009	RG 2nd. gear	1	2
847-3011	RG escape wheel	1	2
847-3102	RG 3rd. gear	1	2

---

Exclusive spare parts for  
#1 Type 870 SEIKO SHUTTER

---

Parts No.	Description	Pcs.	Ref. Page
509-0037	Retainer for type 870	1	1
870-1014	Base plate for type 870	1	2
870-2005	Drive cam for type 870	1	2

Exclusive spare parts for  
#1 Type 871 SEIKO SHUTTER

812-0037	Retainer for type 871	1	1
871-1014	Base plate for type 871	1	2
871-2005	Drive cam for type 871	1	2